

ALL INFORMATION CONTAINED OR DISCLOSED BY THIS DOCUMENT IS CONSIDERED CONFIDENTIAL AND PROPRIETARY BY ANDU ELECTRONICS CO.,LTD. ALL DESIGN, MANUFACTURING, USE, REPRODUCTION, AND ALL SALES RIGHTS, ARE EXPRESSLY RESERVED BY AND TO ANDU ELECTRONICS CO.,LTD. AND COMMUNICATION OF THIS INFORMATION TO OTHERS IS PROHIBITED WITHOUT THE PRIOR WRITTEN CONSENT OF SELITE

DRAWING REVISIONS				
REV	S/N	DESCRIPTION	APPROVED	DATE
A	20080210-08	ORIGINAL RELEASE		

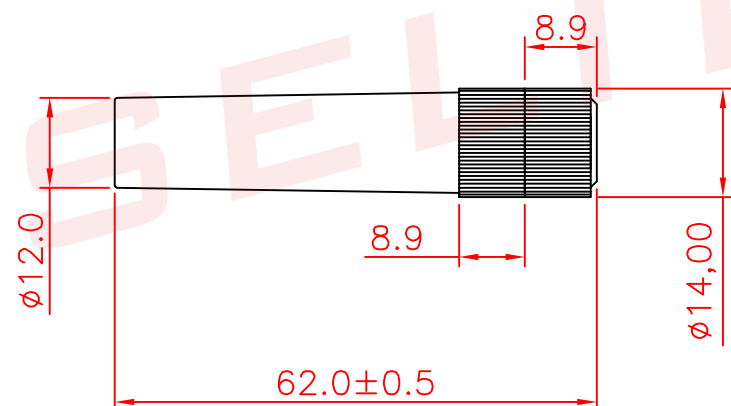
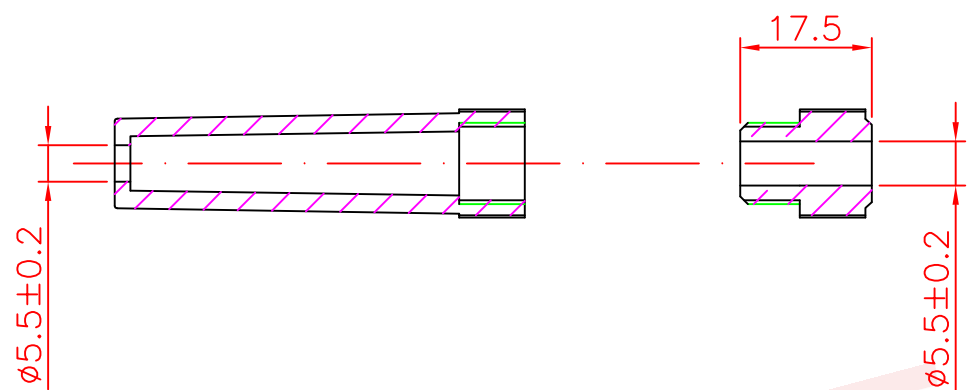

NOTES: UNLESS OTHERWISE SPECIFIED.

1. Applicable: For 3AG(6X32MM tube) Fuse.
2. Electrical: Rated for current up to 30A.
3. Insulating body: Bakelite.
4. Ambient Temp.: -10°C to $+80^{\circ}\text{C}$
5. Contact: Brass.
6. With other wire sizes or leangths available on special order(12#-20#AWG).



东莞市赛力特保险丝制造有限公司
DONGGUAN SELITTEL FUSES MFG CO.,LTD

RoHS COMPLIANT		FUSEHOLDER				CUSTOMER	
UNLESS OTHERWISE STATED							
WALL THICKNESS							
LINEAR	.XX						
ANGULAR	.XXX						
DRAFT ANGLE/SIDE	0.5 °MAX						
BURR & FLASH	0.10 MAX						
BREAK CORNERS	0.20 R.MAX						
PARTING LINE MISMATCH	0.05 MAX						
		DSGN	Tom	12-22-08	SCALE	free	REV A
		DFTS	TOM	12-22-08	SHEET	1 OF 1	
		CHKD			PART NO.		
		APPD			SL-705		