

ALL INFORMATION CONTAINED OR DISCLOSED BY THIS DOCUMENT IS CONSIDERED CONFIDENTIAL AND PROPRIETARY BY SELLI ELECTRONICS CO.,LTD. ALL DESIGN, MANUFACTURING, USE, REPRODUCTION, AND ALL SALES RIGHTS, ARE EXPRESSLY RESERVED BY AND TO SELLI ELECTRONICS CO.,LTD. AND COMMUNICATION OF THIS INFORMATION TO OTHERS IS PROHIBITED WITHOUT THE PRIOR WRITTEN CONSENT OF SELLI

DRAWING REVISIONS				
REV	S/N	DESCRIPTION	APPROVED	DATE
A	2008021012	ORIGINAL RELEASE		
B	2014061322	Change B from 1.2+/-0.05 to 1.25+/-0.1		

Mounting Hole

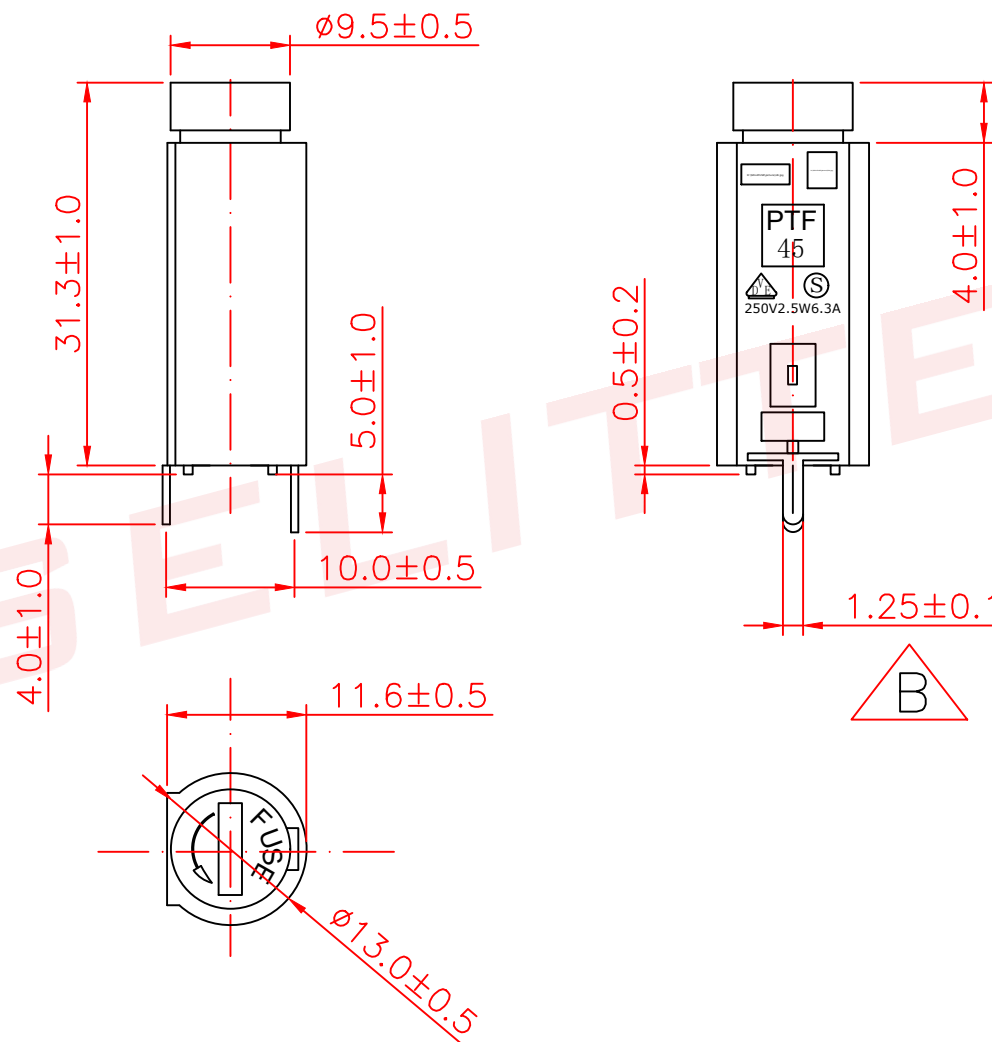

NOTES: UNLESS OTHERWISE SPECIFIED.

1. Applicable: For 5x20mm Fuse.
2. Electrical: Rated for current up to 6.3A250VAC
3. Insulating Base body: PBT
Cap: PBT
4. Terminals: Brass with Tin-plated solderable type.



东莞市赛力特保险丝制造有限公司
DONGGUAN SELITTEL FUSES MFG CO., LTD

RoHS COMPLIANT				PCB Mount Fuseholder FOR 5x20mm fuse				CUSTOMER							
UNLESS OTHERWISE STATED															
WALL THICKNESS		MM		DSGN		Tom		12-22-08		SCALE		free			
LINEAR	.XX	±0.15 MM													
	.XXX	±0.05 MM													
ANGULAR		±0.5 DEG		DFTS		TOM		12-22-08		SHEET		1 OF 1			
DRAFT ANGLE/SIDE		0.5 °MAX													
BURR & FLASH		0.10 MAX		CHKD						PART NO.				REV	
BREAK CORNERS		0.20 R.MAX													
PARTING LINE MISMATCH		0.05 MAX		APPD						PTF-45				B	