

ALL INFORMATION CONTAINED OR DISCLOSED BY THIS DOCUMENT IS CONSIDERED CONFIDENTIAL AND PROPRIETARY BY ANDU ELECTRONICS CO.,LTD. ALL DESIGN, MANUFACTURING, USE, REPRODUCTION, AND ALL SALES RIGHTS, ARE EXPRESSLY RESERVED BY ANDU TO ANDU ELECTRONICS CO.,LTD. AND COMMUNICATION OF THIS INFORMATION TO OTHERS IS PROHIBITED WITHOUT THE PRIOR WRITTEN CONSENT OF Selfifuse

DRAWING REVISIONS				
REV	S/N	DESCRIPTION	APPROVED	DATE
A	20091211-02	ORIGINAL RELEASE		

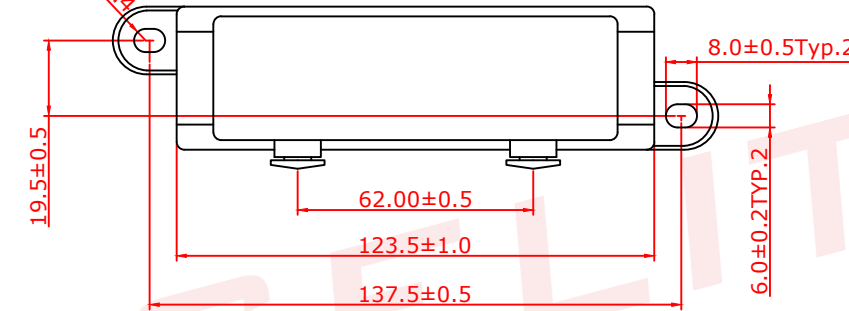
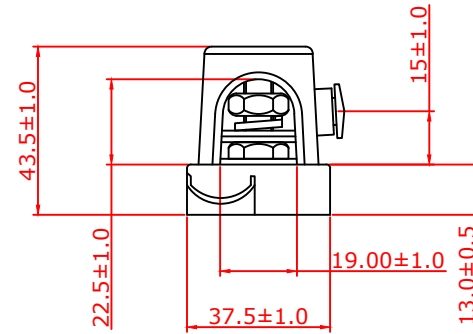
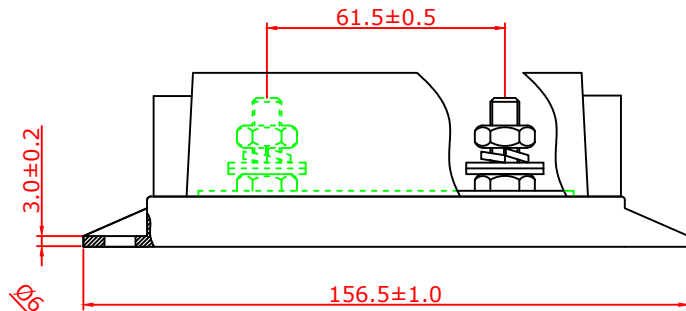

NOTES: UNLESS OTHERWISE SPECIFIED.

- the fuseholder shown are for bolt-on fuse(ANL-B/ANL-C/ANL-E). applications for body builders and medium duty vehicles, for battery and alternator connections and other heavy gauge cables requiring ultra high current protection. Includes protective cover. Includes M8 threaded studs and hex nuts with lock washers, fuse not included.
- rating: DC32V300A; AC220V300A;
- Mounting torque: 5Nm

8	PL-ANL-2	support	2	PVC	Black
7	PL-ANL-1	Plug	2	PVC	Black
6	NT-ANL-1	Cover	1	PC 94_V0	transparent
5	DQ-ANL	spacer	4	carbon steel	Imitation-Au/Ni plated
4	SP-ANL	Spring	2	carbon steel	Imitation-Au/Ni plated
3	NT-ANL	Nut	4	carbon steel	Imitation-Au/Ni plated
2	BL-ANL	Bolt	2	carbon steel	Imitation-Au/Ni plated
1	PB-ANL	BASE	1	PA+GF 94_V0	Black
ITEM	P/N	DESCRIPTION	QTY	Material	REMARKS



东莞市赛力特保险丝制造有限公司
DONGGUAN SELITTEL FUSES MFG CO., LTD

FUSEHOLDER				CUSTOMER	
FOR ANL bolt-on Fuse					
UNLESS OTHERWISE STATED					
WALL THICKNESS	MM				
LINEAR	.XX	±0.15	MM		
	.XXX	±0.05	MM		
ANGULAR		±0.5	DEG		
DRAFT ANGLE/SIDE	0.5	°MAX			
BURR & FLASH	0.10	MAX			
BREAK CORNERS	0.20	R.MAX			
PARTING LINE MISMATCH	0.05	MAX			
DSGN	Tommy	11-12-09	SCALE	free	
DFTS	Tommy	11-12-09	SHEET	1 OF 1	
CHKD			PART NO.		
APPD			ANL-H5		
					REV
					A